

AIUXITY

USER GUIDE

AIUXITY

Invites HiFi into your family

Content

Foreword	4	Warranty and replacing parts	18
Introduction	4	LIMITED WARRANTY	18
About this manual.....	4	How to get warranty service	18
Turning the Hifi setup on and off*	4	Miscellaneous.....	18
General information.....	5	Demo equipment	19
Getting started	5	WARRANTOR.....	19
Unpacking the box	6	Replacing parts	19
Specifications	6	Warranty outside Denmark	20
Using the touch display.....	7	Disclaimers	20
How to connect an Alluxity product	7	Safety and handling information	21
Power save mode.....	7	Important safety information.....	21
How to change a broken fuse.....	8	Handling	21
Icon Explanation	9	Repairing	21
The User Interface	10		
The Pre Two	10		
The Pre/Int One	12		
The Power One.....	14		
How to change Input and Output	15		
Using the Streamer	16		
MCONNECT interface	17		

Foreword

First of all, thank you for choosing an Alluxity product.

The Alluxity products are built to be very user-friendly and very modern. One of the main focuses has been making a product that the High-end industry has not seen before, but still being faithful to the 'old' techniques; so basically mixing the old school with the new school.

Introduction

About this manual

This is an overall manual that covers all of the basics. It describes how to connect your Alluxity product and how to use it. Although some operations are self-explanatory, we strongly suggest you read this manual before using the products to avoid damaging the unit or yourself.

The manual is designed to be as helpful as possible but please let us know if there is something we have not explained clearly enough.

Turning the Hifi setup on and off*

Always turn on your products beginning from the source:
CD player / Music server > Pre-amplifier > Power-amplifier

Always turn off your products in reverse order:
Power-amplifier > Pre-amplifier > CD player / Music server

**Doing otherwise may cause harm to your equipment.*

General information

There are a few things you should know about the product to prevent damaging it:

- The products are heavy, so be very careful when moving it around. We suggest that you are always 2 people lifting any of the products to prevent dropping it and cause harm to the unit and yourself.
- When any of the Alluxity products have been running for more than 10 minutes, the input and output selections are saved as the default.
- Pressing the touch display too hard will damage it and leave a darker area. This damage to the products is not covered by warranty. We suggest that you use the tip of your finger and/or a bit of your nail.

Getting started

Unpacking the box

After you have opened the top of the box and gently removed the protecting foam from the top and from the sides, you can now really gently take out the amplifier.*

*To prevent dropping the product or injuring yourself when lifting an Alluxity product, please do not under any circumstances lift any Alluxity products yourself. Always be at least two people to lift the product.

Specifications

Pre One

Inputs : Total of 5 – 2x Unbalanced RCA and 3x Balanced XLR
Outputs : Total of 3 – 1x RCA, 1x XLR and a Bypass out (RCA)
Dimensions: 43.5 x 10.5 x 31.5 cm / 7.1 x 4.1 x 12.4 inch
Weight : 14,0 Kg / 30 Pounds

Pre Two

Inputs : 2 x Analog (Balanced + Unbalanced)
5 x Digital (AES, S/PDIF, USB, Optical and Streamer)
Outputs : Total of 3 – 1x RCA, 1x XLR and a Balanced XLR for By-amping.
Dimensions: 43.5 x 10.5 x 31.5 cm / 7.1 x 4.1 x 12.4 inch
Weight : 14,0 Kg / 30 Pounds

Power One

Inputs : 2 x Analog (Balanced + Unbalanced)
Dimensions: 43.5 x 10.5 x 48 cm / 7.1 x 4.1 x 18.9 inch
Weight : 31.0 Kg / 83.0 Pounds

Power Two

Inputs : 2 x Analog (Balanced + Unbalanced)
Dimensions: 43.5 x 10.5 x 31.5 cm / 17.1 x 4.1 x 12.4 inch
Weight : 17.5 Kg / 38.5 Pounds

Int One

Inputs : Total of 5 – 3x Unbalanced RCA and 2x Balanced XLR
Dimensions: 43.5 x 10.5 x 31.5 cm / 17.1 x 4.1 x 12.4 inch
Weight : 17.5 Kg / 38.5 Pounds

Mono One

(pr. CH)
Inputs : 2 x Analog (Balanced + Unbalanced)
Dimensions: 43.5 x 10.5 x 31.5 cm / 17.1 x 4.1 x 12.4 inch
Weight : 17.5 Kg / 38.5 Pounds

Using the touch display

All the Alluxity products uses a 5 inch, 800 x 480 pixels resistive touch display. The display is a robust industry screen that is highly resistant to cracks and therefore is not as sensitive as your average smartphone touchscreen. This means that you will have to press gently on the display with the tip of your finger and/or with your fingernail for it to react.

However, pressing too hard in the display can cause damage to it.

If you experience that there is no reaction from the touch display, do not increase the pressure, but contact the nearest Alluxity cooperating partner.

How to connect an Alluxity product

When connecting an amplifier it's very important not to switch around input and output.

Doing so will cause harm to the product.

To connect your Pre One properly, make sure that you take the left and right output from your source and connect it to the same left and right input on the Pre One.

Right ● Red

Left ○ White

The inputs must be either left and right RCA 1 or 2, XLR 1, 2 or 3.

Now connect either the RCA or the XLR outputs from the preamplifier to the equal input on the power amplifier

(RCA ↔ RCA, XLR ↔ XLR).

How to change a broken fuse

If a fuse is broken then gently remove the little cap in the Power Inlet and replace the fuse, as shown in the picture below.

Pre One : 230V = 0.5A and 115V = 1A

Power One : 230V = 6.3A and 115V = 10A

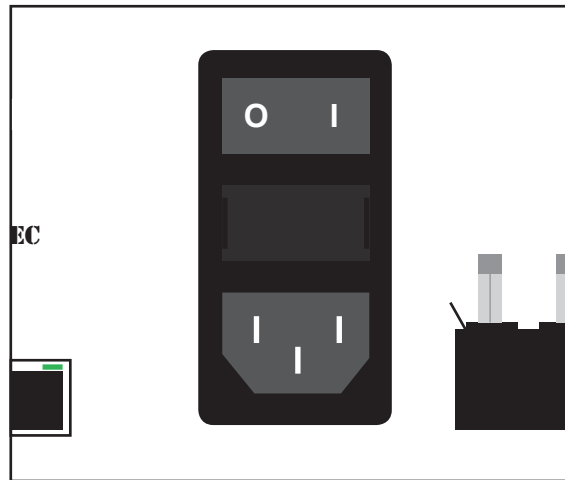
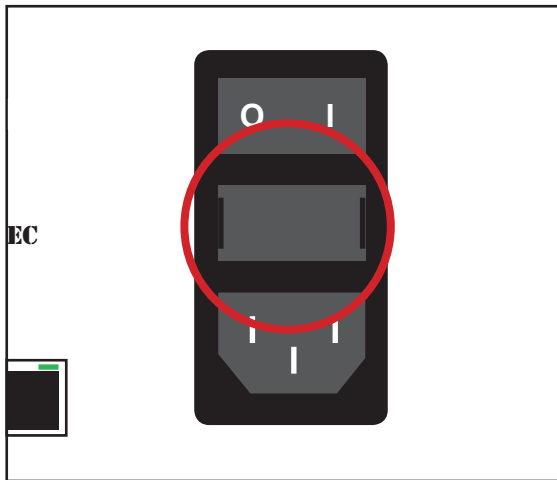

Good



Broken

Icon Explanation



Standby button.

This puts the amplifier into and out of Standby mode.

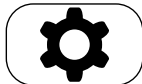

Setup button.

Pressing this button will give you access to the Setup Interface.

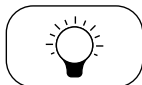

Brightness button.

Adjusts the brightness level on the display.



Home button.

This button is used to go from the Setup Interface to the Main Interface.



Volume Up button.

Pressing this will increase the volume.



Volume Down button.

Pressing this will decrease the volume.



Mute button.

Pressing this will mute the amplifier.



Unmute button.

Pressing this will unmute the amplifier.

This icon is only showed when the amplifier is muted.



XLR-inactivated button.*

Pressing this will activate either the XLR output or the XLR Input 1-3, depending on the location of the button.



XLR-activated button.

This icon is showing which of your channels is active.

*The XLR button is used in this User Guide because it's the default Output channel, when you turn on your amplifier for the first time.

The User Interface

Pre Two

Main Interface

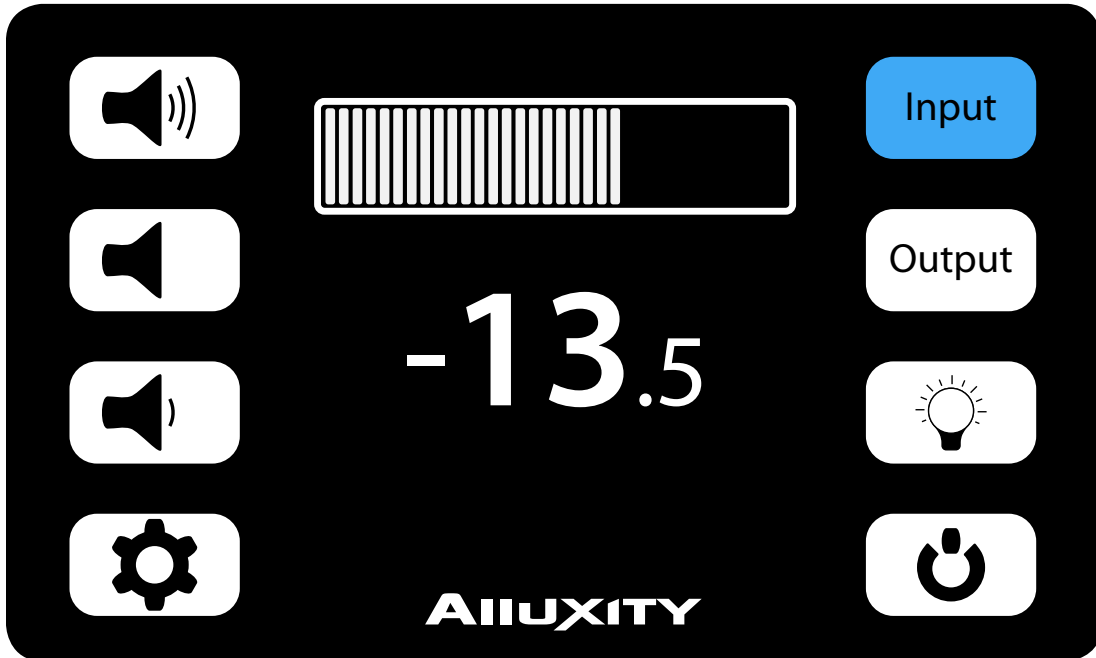

The Main Interface has the following buttons:

- Volume Up
- Mute / Unmute
- Volume Down
- Setup

- Input
- Output
- Brightness
- Standby

Setup Interface

Pre Two

Main Interface

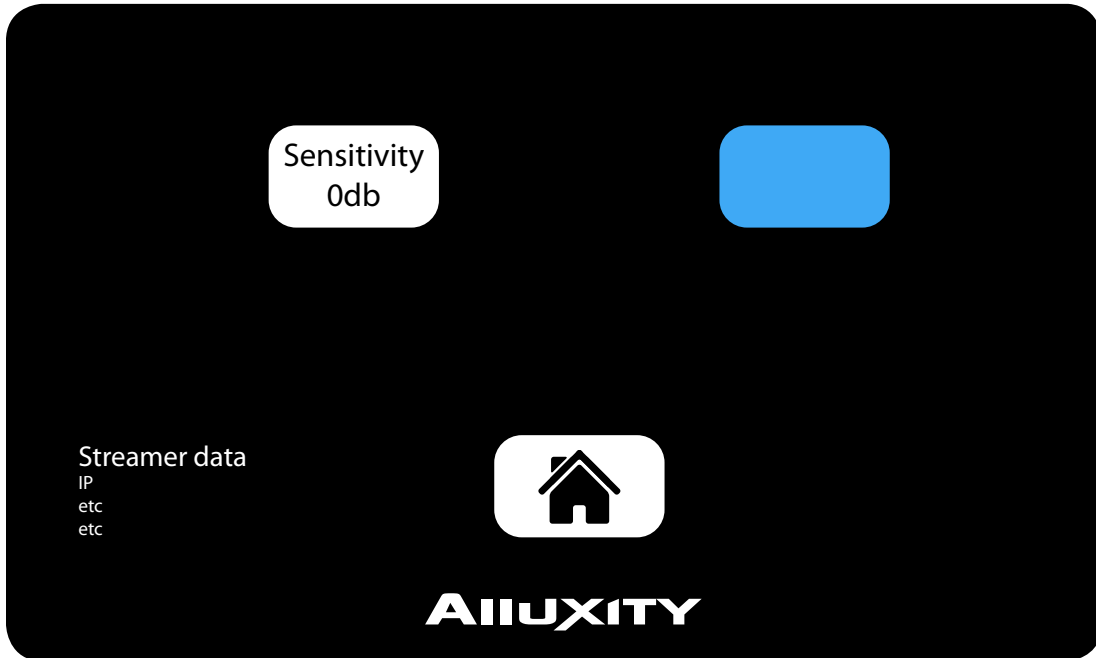

The Setup Interface provides you with the options of changing:

- Input sensitivity (0dB og -6dB)
- Color selection

To turn off the background light of the touchscreen, press the Brightness icon for 1.5 seconds and wait 5 seconds for the screen to turn off. To turn the screen on again press anywhere on the screen.

The User Interface

Pre/Int One

Main Interface

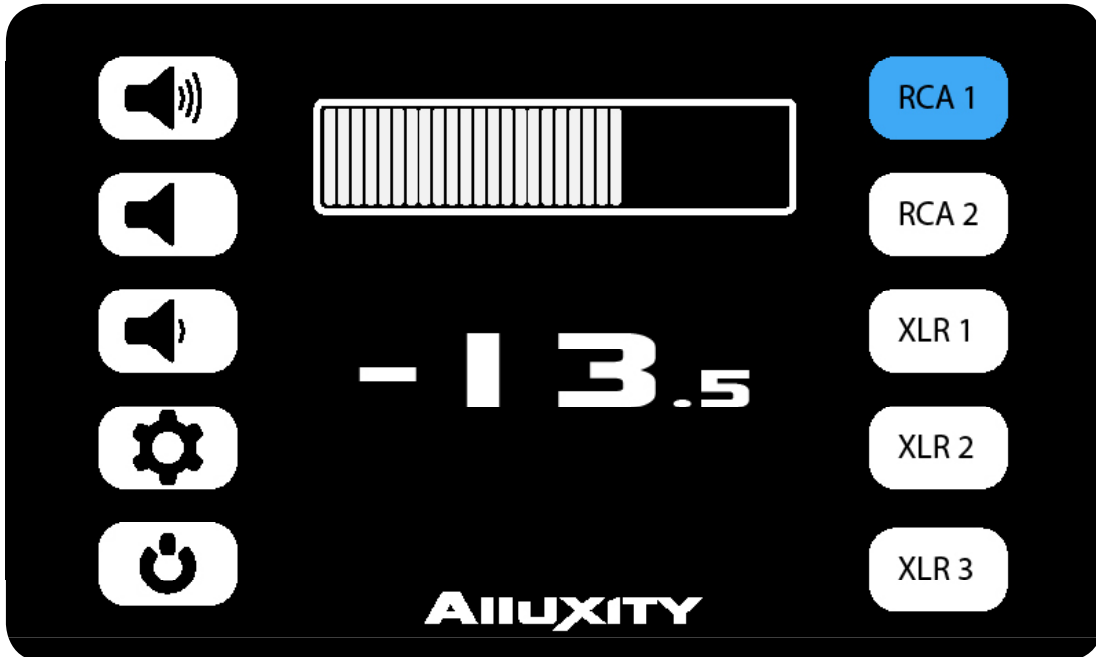

The Main Interface has a variety of options:

- Volume Up
- Mute / Unmute
- Volume Down
- Setup (see Setup Interface for more information) (not included in Int One, Brightness icon instead)
- Standby

• The Volume

• The different Inputs from RCA 1-2 to XLR 1-3 (RCA 1-3 and XLR 1-2 on Int One)

Setup Interface

Pre One

Main Interface

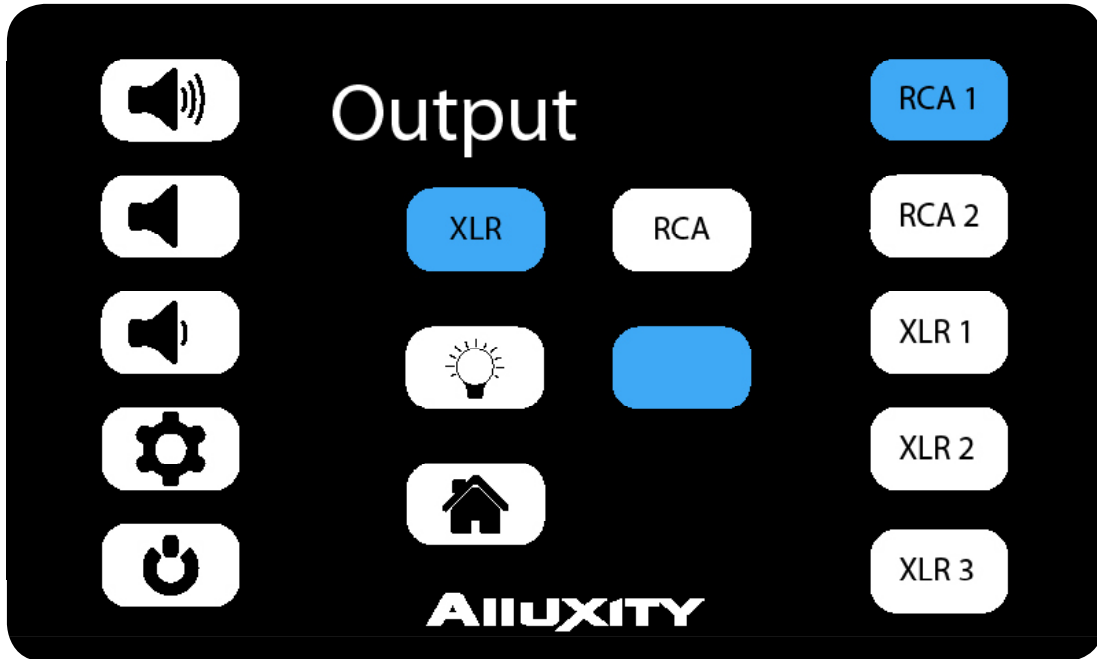

The Setup Interface provides you with the options of changing:

- Output (XLR or RCA)
- Brightness level

To turn off the background light of the touchscreen, press the Brightness icon for 1.5 seconds and wait 5 seconds for the screen to turn off. To turn the screen on again press anywhere on the screen.

The User Interface

The Power One + Mono One + Power Two

Main Interface

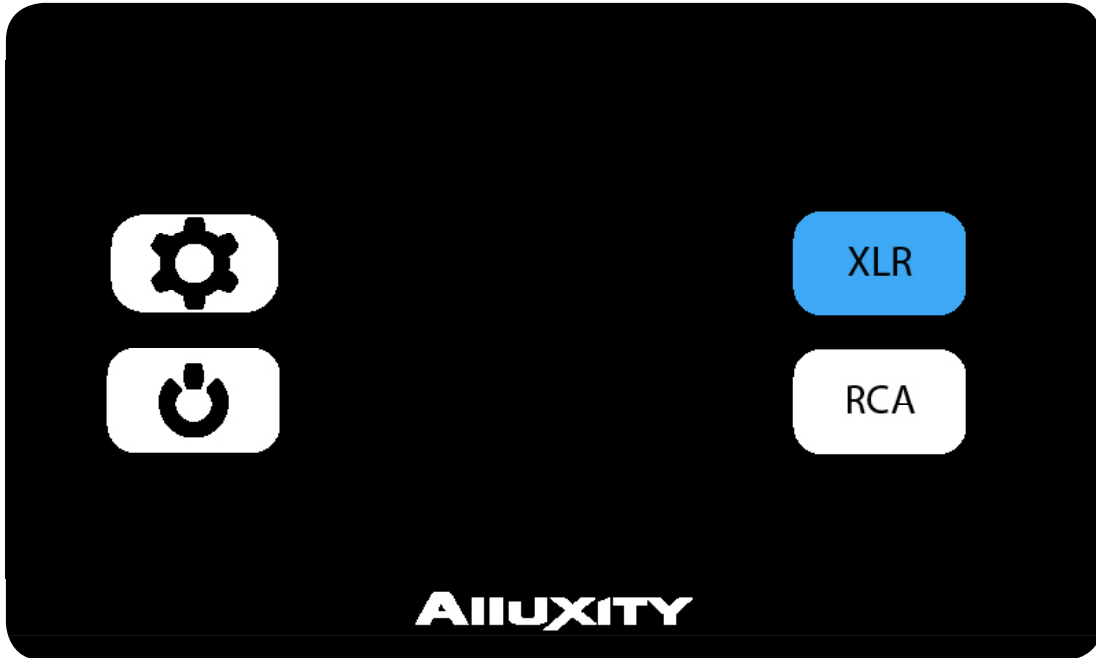

The Power-amp One Main Interface provides you with the options:

- Change Input
- Brightness
- Standby

To turn off the background light of the touchscreen, press the Brightness icon for 1.5 seconds and wait 5 seconds for the screen to turn off. To turn the screen on again press anywhere on the screen.

How to change Input and Output

How to change Input and Output

You change the input and output different places:

Pre-amp One

The 5 different **inputs** are all located on the Main Interface and on the right side. Here you have:

- RCA 1
- RCA 2
- XLR 1
- XLR 2
- XLR 3

These are input 1-5.

To change the input, simply press gently on the button on the screen so it will turn green.

The green color shows that this is the active input.

To change the **output**, press the Setup button (the mechanical wheel), and select between the XLR and the RCA output.

Power-amp One

The power amplifier only uses inputs and only has 2 different inputs, the XLR and the RCA.

To change the input, simply press gently on the button until it turns green.

Using the Streamer

Overview of the functions

The Converse Digital streaming module supports a variety of streaming services:

1. Tidal
2. Qobuz
3. Apple airplay
4. Spotify Connect
5. MQA
6. NAS Playback

Using the different services

To access Tidal, Qobuz and NAS Playback, you will need to download the MCONTROL application. Spotify Connect and Apple Airplay can be streamed directly from their respective applications.

The application works as a simple player interface where you can choose between supported devices, rename and update them.

Note that the volume control is disabled to work with the Alluxity amplifiers in case of an accidental mistouch that brings the volume level up too high.



MCONNECT interface

The interface is very simple. It shows the current playing track unless you're playing through Spotify or Apple Airplay. In the bottom you have the buttons for the different interfaces within the app.

Player: Play, pause, previous or next track. Loop and shuffle in the top next to the progress bar.

Queue: Shows the current playlist.

Favorites: Mainly used for NAS Playback to access your playlists and favorite folders. You can mark a folder as a favorite while browsing.

Browse: Here you access Qobuz, Tidal and your files on a local NAS drive. Pressing Tidal or Qobuz in the MCONNECT app will give you their respective interface where you can log in and browse.

Play to: Here you choose which device to play to.

For additional information, please visit:

http://www.conversdigital.com/eng/product/product03.php#id_17

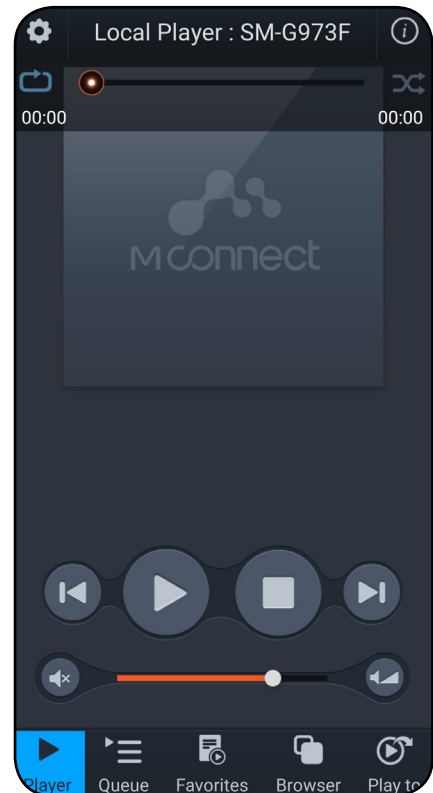

Warranty and replacing parts

LIMITED WARRANTY

The warranty covers manufacturing defects in components, material and workmanships, for two (2) years to the first end-user buyer or no later than three (3) years from the date of shipment to the authorized Alluxity cooperating partner, whichever comes first.

If the products has been used or handled other than in accordance with the instructions in the manual, has been abused, misused, damaged by accident, neglected, got a transport damage, or has got a defect due to being repaired or tampered with by anyone who is not authorized to do so, the warranty does not apply. Damage or cosmetic defects are equally not warranted as the above situations.

How to get warranty service

If you as a customer experience problems with any of the Alluxity products, you will have to turn off the equipment instantly, pack it in the original box and ship it to the local cooperating partner, with a photocopy of the original purchase receipt.

The receipt must clearly list model, serial number, and date of purchase, name and address of the purchaser and authorized dealer, and the price paid by the purchaser.

Miscellaneous

Any implied warranties relating to the above product shall be limited to the duration of this warranty. The warranty does not extend to any incidental or consequential costs or damages to the purchaser. Some countries do not allow limitation on how long an implied warranty lasts or exclusion or limitation of incidental or consequential damages, so the above limitations or exclusions may not apply to you. This warranty gives you specific legal rights, and you may also have other rights which vary from country to country.

Demo equipment

Equipment used by an authorized cooperating partner for demonstration purposes is warranted to be free of manufacturing defects in materials and workmanship for a period of two (2) years from the date of shipment to the authorized cooperating partner. After the first year, demo equipment needing warranty service must be packed in its original box and returned to AVM-TEC by the cooperating partner at his or hers sole expense. AVM-TEC will pay return freight of its choice. A returned product must be accompanied by a written description of the defect on an ALLUXITY RETURNED GOODS AUTHORIZATION form. Dealer-owned demonstration equipment sold at retail within two (2) years of date from shipment to the dealer is warranted to the first retail customer to be free of manufacturing defects in materials and workmanship for the duration of the two (2) Year Limited Warranty remaining (as measured from the date of shipment of the equipment to the Alluxity partner. In the event warranty service is needed under these conditions, the owner of the equipment must provide a copy of his purchase receipt, fulfilling the requirements described in "How to get warranty" just above.

WARRANTOR

Inquiries regarding the above Limited Warranty may be sent to the following Address:

AVM-TEC
Dueoddevej 6C
DK7400 Herning
Denmark
Att.: Alexander Vitus Mogensen

Replacing parts

If an owner of an Alluxity product experience problems that can only be fixed by replacing an electronic part inside the product, the owner can always have this part replaced by an authorized Alluxity cooperating partner, even if the warranty has expired. If the warranty has expired, there will be a specific price on the replacement unit, depending on which unit that will be needed to be changed.

Warranty outside Denmark

AVM-TEC has authorized distribution in many countries in the world. In each country, the authorized importing retailer or distributor has accepted the responsibility for warranty of products sold by that retailer or distributor. Warranty service should normally be obtained from the importing retailer or distributor from whom purchased your product. In the unlikely event of service required beyond the capabilities of the importer, Alluxity will fulfill the conditions of the warranty. Such products must be returned at the owner's expense to the Alluxity factory, together with a photocopy of the bill of sale for that product, a detailed description of the problem, and any other information necessary return shipment. In many cases the retailer you purchased the product from, will handle this for you.

Disclaimers

Alluxity reserves the right product without obligation to purchasers of previously manufactured products and to change the prices or specifications of any product without notice or obligation to any person. Alluxity reserves the right not to cover any damage done by mishandling or misusing Alluxity products in accordance to this manual.

Safety and handling information

Important safety information

WARNING: Failure to follow these safety instructions could result in fire, damage to the product, to other property, or injuries to yourself or other. Please read all the safety information below before connecting any of the Alluxity products.

Handling

Handle your Alluxity products with care. The products are milled out of one piece of aluminum and contains heavy transformers and electronic. The amplifiers or other properties can be damaged if the product is dropped. If possible, always have two people to lift the products to avoid dropping the unit, or hurting yourself. Do not connect the products wrongly as this can cause damage to the unit and/or to the other equipment which are connected. The Standby function does not turn off the amplifier, but only puts it in power save mode. You should always turn off the amplifiers by using the power switch on the back, before connecting any cables or moving the amplifiers.

Repairing

Do not under any circumstances open any of the Alluxity products yourself; this is reserved for the local Alluxity cooperating partner. The Alluxity products have been constructed so it's easy to replace any part inside the amplifiers, but you should under no circumstances open any of the Alluxity products. If doing so, any type of warranty will be lost, and it can cause injury to the products and yourself.

ALLUXITY

www.alluxity.dk